

# USB Wall Socket ( WM-USB02x1-A )

## USB Specifications:

1. Input : 100-240V~50/60Hz, MAX 0.5A
2. Total Output : 5.0V $\overline{=}$ 2.1A
3. Working Temp. : -10 $^{\circ}$ C~60 $^{\circ}$ C
4. Humidity : 10%~95%RH

## Socket Specifications:

1. Output : 240V~50Hz, MAX 10A

## Function:

1. Two USB ports with 2 individual LED indication (lights up when charging).
2. One 240V, 10A, A.C socket, Australian standard with switch controlled.

## MOUNT Details:

### USB charger dimensions :

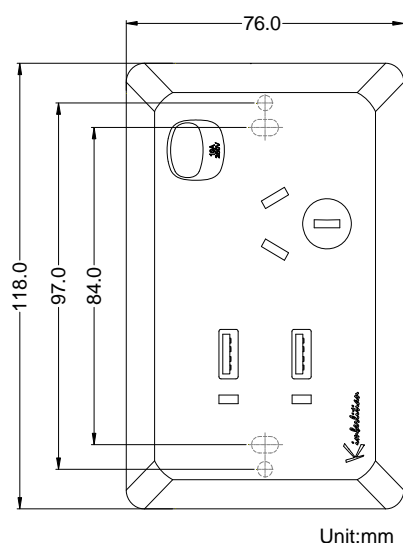

### 1. Test:

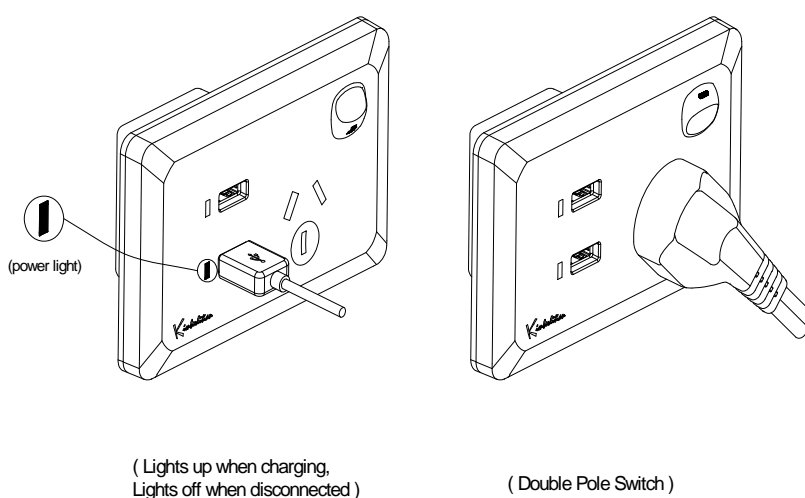

### 2. Cables Installation :

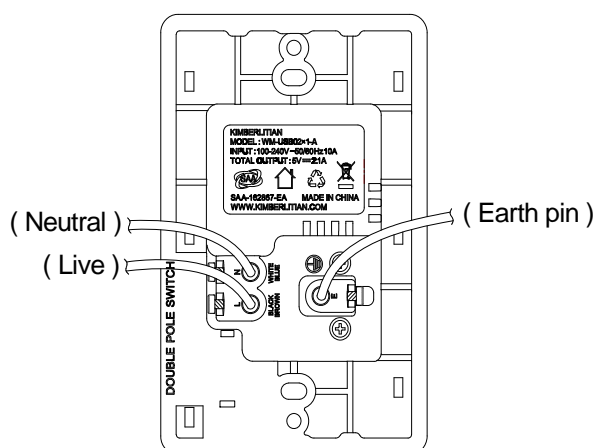
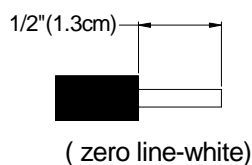
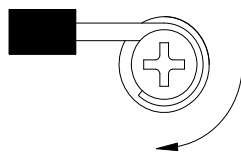
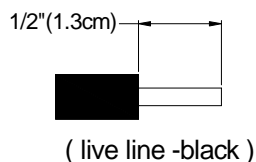
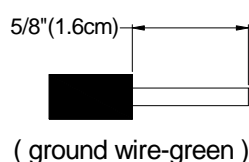

( ground wire )

( live line / zero line )

## Warning:

1. Keep away from flammable and combustible source
2. Not water-proof
3. Install at places beyond reach of children and pets
4. it is dangerous to open the module under high voltage